



**FIRE**RETARDANT  
EXTERIOR GRADE COMPACT LAMINATES



# First Impression

EXTERIOR CLADDING SOLUTION

AMULYA CLADDING

The easiest way to make a great  
**first impression**

Presenting FIRST IMPRESSION - EXTERIOR CLADDING SOLUTION



Stay tension-free with

**10 YEAR  
WARRANTY**

Orange Line  
of Trust



Purbanchal Laminates Pvt. Ltd.

**CORPORATE OFFICE :**

Goyal Avenue, Office No. 101 & 102, 1st Floor,  
Plot No. 318, Ward 12-B, Opp. Old LIC Block,  
Gandhidham - Kutch, Gujarat - 370201  
CRM No.: +91 2836 231468  
Email: [crm@amulyamica.com](mailto:crm@amulyamica.com)

**TOLL FREE NUMBER: 1800-233-1468**



DOWNLOAD AMULYA MICA APP



FOR MORE DETAILS, VISIT :  
[www.amulyamica.com](http://www.amulyamica.com)



# LAMINATES

## GHAR SAJAYE SAATH NIBHAYE

Amulya Mica is one of the fastest-growing decor brands of India that specializes in Laminates, Plywood, WPC/PVC boards and Doors. Established in 2004, and recognized by the Indian government as a 'Star Export House', Amulya Mica now boasts of an international presence in over 20 countries along with a pan India presence. With multiple industry benchmark awards and recognitions under its belt, Amulya Mica has been steadily winning over the hearts of customers en route to becoming one of India's Most Trusted Decor brands.

Amulya Mica's Cladding is a high-quality construction product that is primarily used in facade claddings and exterior applications. It is perfect for buildings that require ventilated facades. Amulya Cladding is made of superior Kraft paper that has high color retention. Pure Phenolic Resin and superior UV technology combined with high pressure and temperature production process makes it fire retardant and erosion resistant, thus making exterior facades durable and long-lasting.

Purbanchal Laminates Pvt Ltd "Amulya Mica" has been awarded with Bronze Medal for National Award for Manufacturing Competitiveness 2019-20 (NAMC) by International Research Institute for Manufacturing, India.



# Applications

- Facade Cladding
- Balcony Cladding
- Soffits
- Cladding Member for gate & garage
- Duct Covering
- Signages
- Pedestrian Shelters
- Prefab Huts
- Kiosk
- Partitions
- Canopy
- Fences, Rails & Screens
- Ventilated Facades
- Louvers

**Range:** 6mm, 8mm, 10mm, 12mm & up to 15mm

**Standard size:** 1220mm x 2440mm



**Limited Warranty:**

Amulya Cladding Warranty for 10 Years of Exterior Grade Laminate from the date of delivery of the product to the buyer within the frame work of the properties mentioned in Test Standard.

Guarantee will be valid when installation will be done according to Amulya Installation Guideline only. For proper installation & fabrication please refer to Amulya Guideline Book.

This will exclude if any damage been done by mishandling as a result of improper installation and maintenance of the product





EX 3229 SF | Tyrol Pine

## Glamorous

This smart range is a glimpse of glamorous propositions with a cutting edge style.



EX 3047 SF | Argentine Capisco III



EX 3154 SF | Canyon Monument I

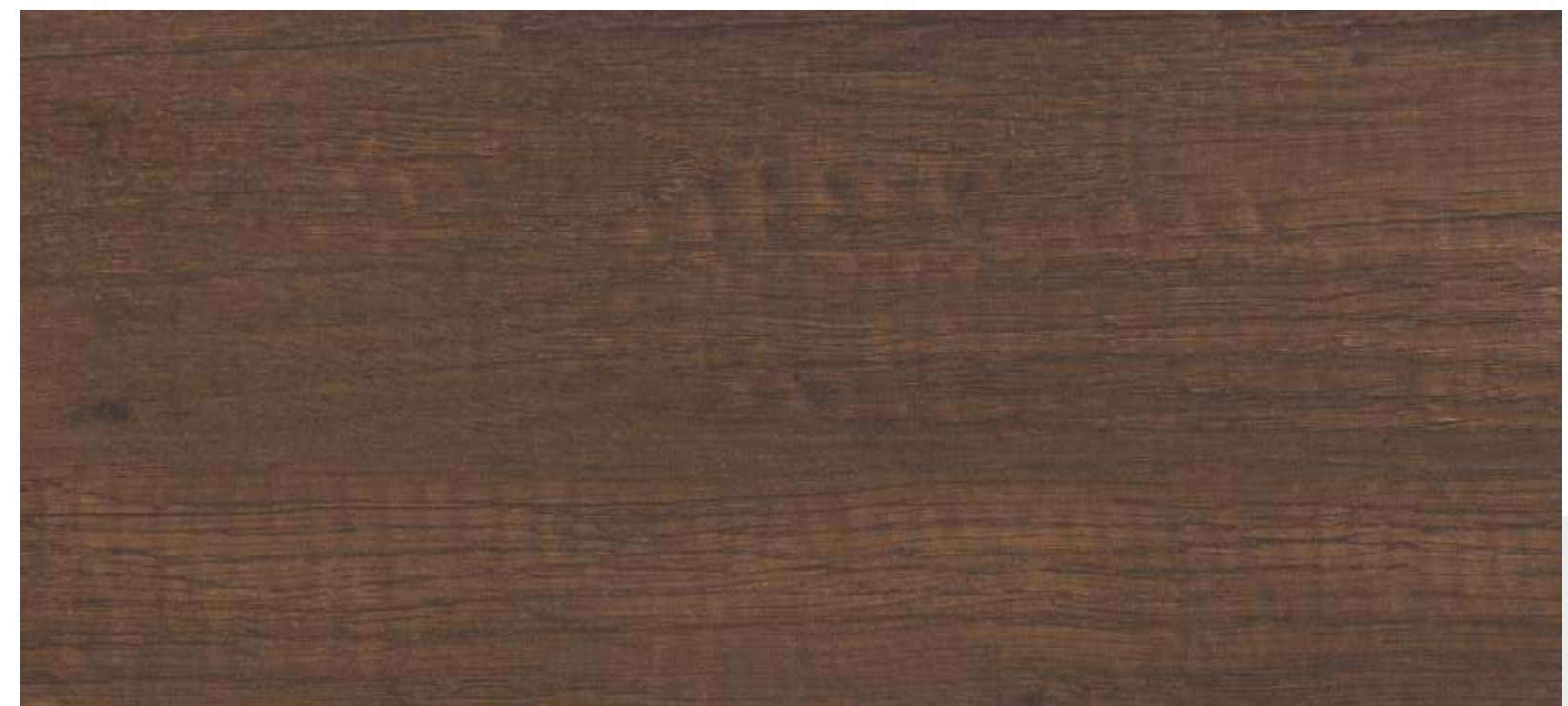

EX 3150 SF | Canyon Monument



EX 3151 SF | Hastings Sandal





EX EI38 SF | Jackpot Limba Light



EX EI18 SF | Cuneo Oak Tan



EX 3325 SF | Jabloka



EX EI37 SF | Delano Oak Brown



EX 3218 SF | Dyed Zebrano Gold



EX EI30 SF | Westminster Oak Dark





EX 3155 SF | Cyprus Metal



EX E135 SF | Barmuda



EX 3366 SF | Travertine





# Splendour

The intent to create exclusive surfaces that explore splendour of a definite demeanor is in itself a fabulous area.

EX 3263 SN | Rustic Metal Work



EX 3223 SN | Metal Work



EX 3335 SN | Komaba Dark



EX 3225 SN | Oriental Black

COMING SOON







EX 3180 RE-II | Radiant Crotch



EX 3181 RE-II | Browny Crotch

Spraying an array of enamoring patterns, this ornate range is sure to impress and spread its finesse.



EX 3079 RE-5 | Exotic Coffee Wood



EX 3080 RE-5 | Exotic Natural Wood



# Designs

Plain and simple yet profound, these designs are made to give you a chance to flaunt with a swanky flair.



EX 1813 SF | Dark Grey

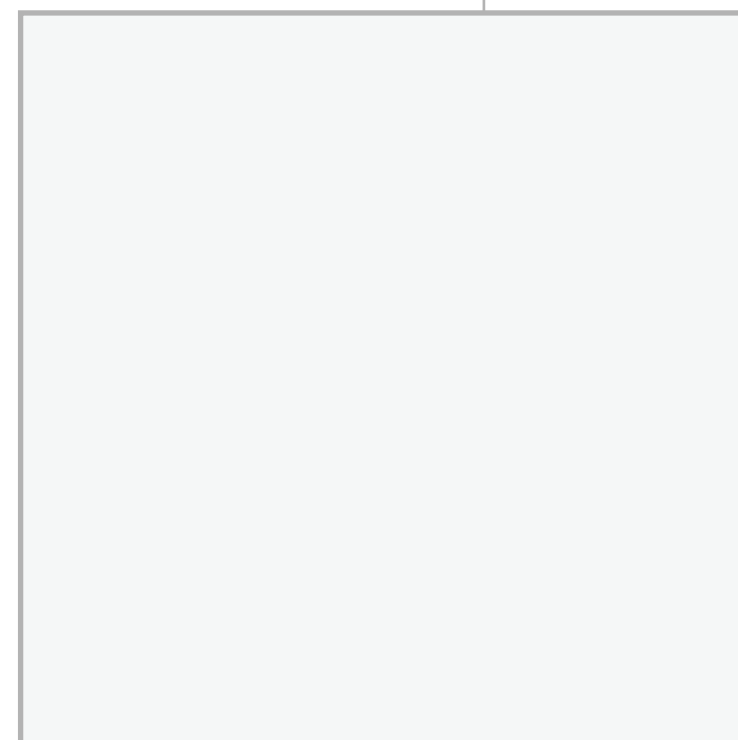

EX 1001 SF | Snow White

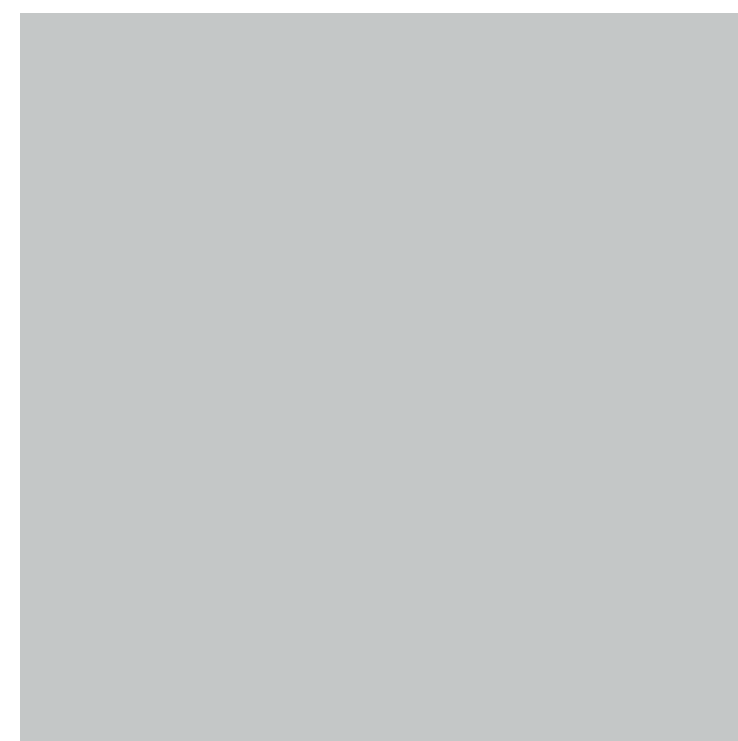

EX 1203 SF | Allergy Grey

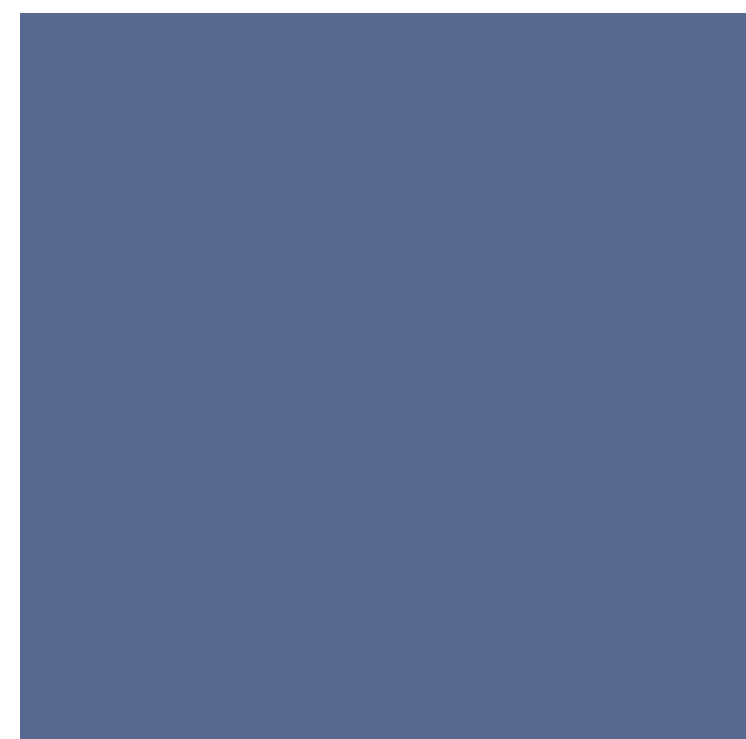

EX 1414 SF | Navy Blue



EX 1503 SF | Blood Red



COMING SOON



COMING SOON





## AMULYA CLADDING USED HERE



Aggarsain Bhawan, Ultimate Fabricator - Hissar



Munni Devi Shivhare, Civil Line - Nagpur



Shree Maheshwari Seva Sadan - Surat



H.N. 930, Sec - 14 Hissar



G.T. Commercial Complex, Main Bazar - Bahal



AMULYA CLADDING USED HERE



Rajasthan Hospital - Ahmedabad

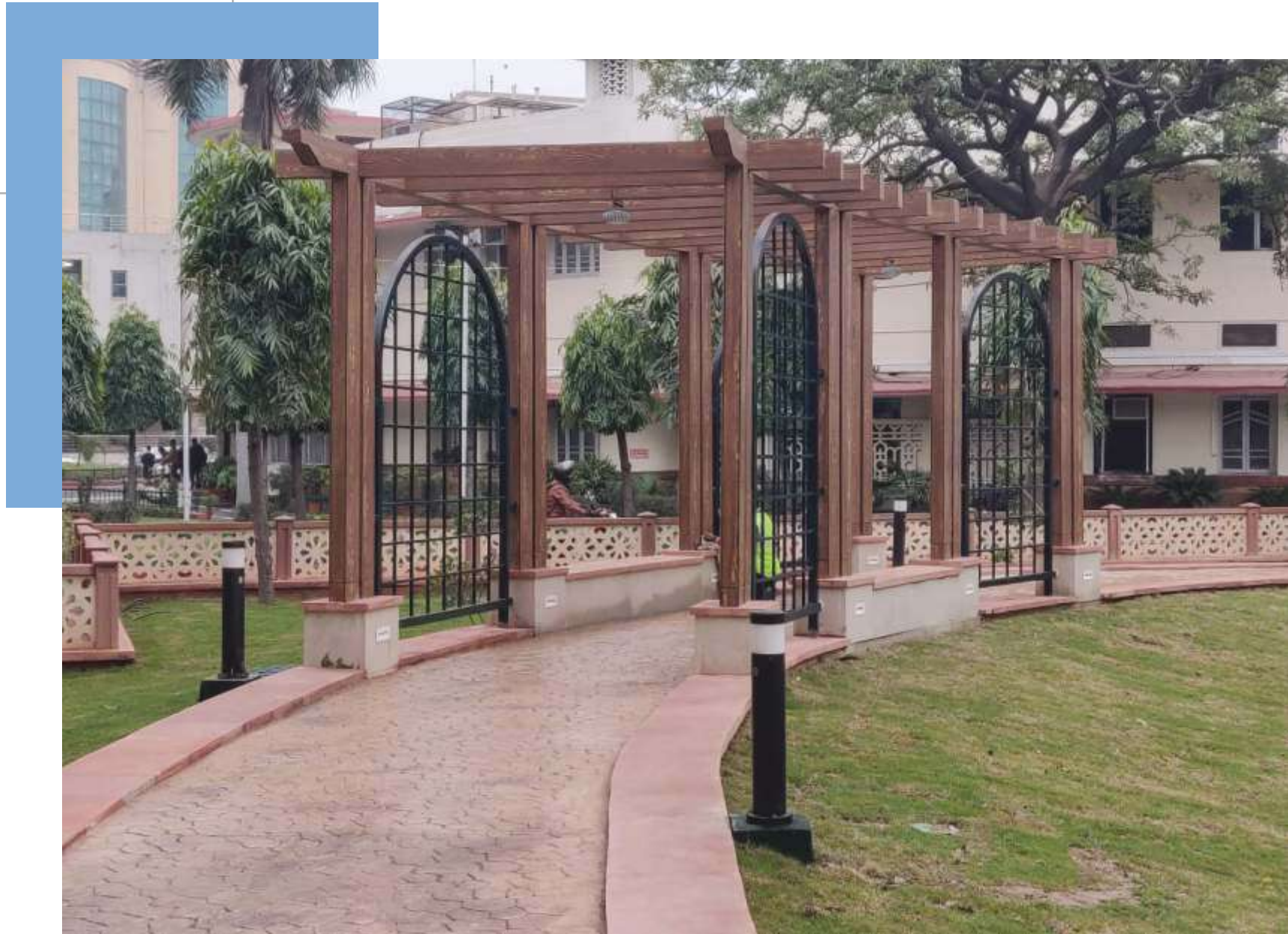

UPSC (CPWD) - Delhi



Mr. Mridul Singhvi - Gandhidham



Gautam House - Gandhidham



# INSTALLATION GUIDE

 RIVITED	 RIVITED FIXING	 FINISHED WALL
 ADHESIVE	 ADHESIVE FIXING	 FINISHED WALL
 Z-CLIP	 Z-CLIP FIXING	 FINISHED WALL

## PROPERTIES

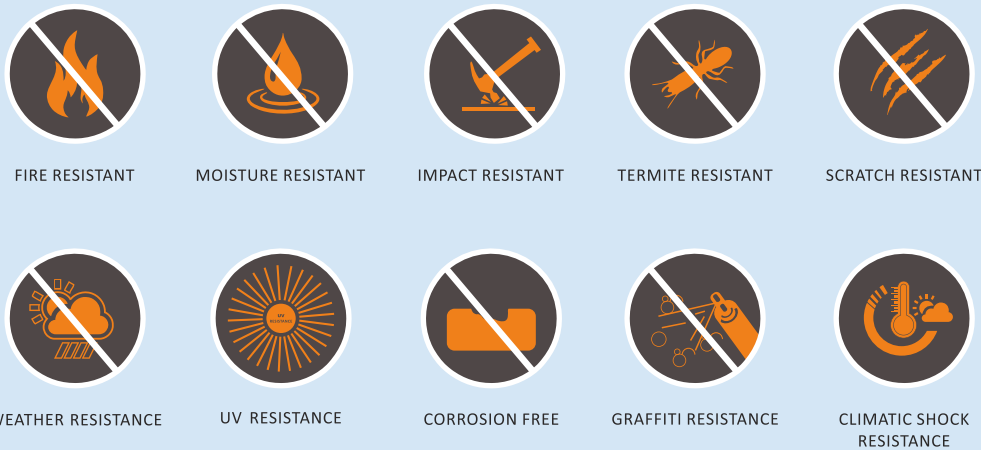

# Wall Cladding- Rivet Type System



**AMULYA** External Wall Cladding can be installed by using essential fasteners of non corrosive material like aluminium & stainless steel, head of the rivets are color with powder coated so as to compliment the Amulya External Wall Cladding range and are UV coated for better color fastening Properties.

Diameter of hole in Amulya External Wall Cladding panels:

- Sliding points: 8mm as required
- Fixed points: 5mm
- Diameter of hole in aluminium substructure:5.1mm

Amulya External Wall Cladding Installation Methods:  
Riveting system  
Amulya External Wall Cladding Panels of 6mm & 8mm are suitable for riveted system on an aluminium Substructure. This system is applied to high rise buildings or used as supporting gluing systems to provide extra solidity.

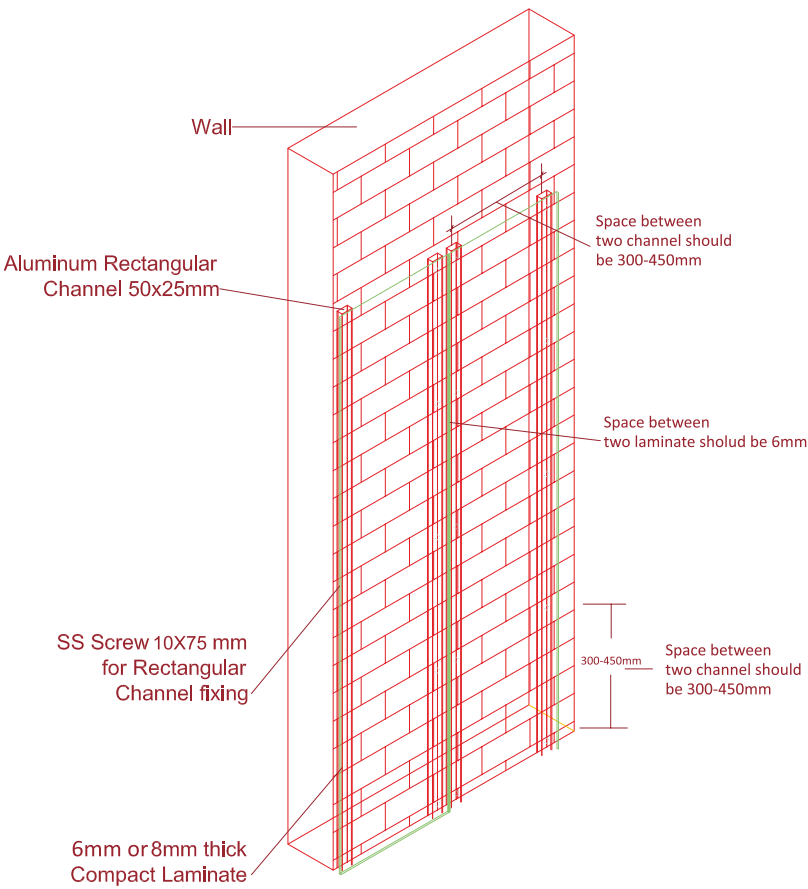

## Aluminium Substructure:

The aluminium Substructure has to adhere to national standards and has to be installed in accordance with the manufacture Specification for the substructure. the aluminium substructure basically consists of vertical supports profiles which are mounted on the wall using brackets. Due to the material properties of Amulya External Wall Cladding panels, fixed points and sliding points need to be made in order to fix the panels.

## Edge Spacing:

The Edge spacing must be kept in consideration for the reasons of stability and flatness, without fail. At least 8 mm wide joints must be made so that changes in size can take place without any interruptions. With the change in temperature, the metal sub-constructions change their dimensions. However the dimensions of claddings alter by relative humidity fluctuations. These changes in the size of sub construction and cladding material can be opposite to each other. While installing keen attention must be paid to the expansion clearance. The thumb rule for calculating required expansion clearance is:

$X \text{ or } Y(\text{in mm})/500 = \text{Expansion Clearance.}$

## Specifications

- Aluminum cube channel should be of 50\*25\*2mm thick or 40\*40\*2mm thick. Every junction of two panel's aluminum cube channel should be of 63\*25\*2mm thick or 75\*40\*2mm thick.(channel should be powder coated)
- Channel fixing will be fixed using 75mm\*10mm screws on the wall in distance of 900mm c/c.
- Riveting hole on sheet should be 8mm.
- Riveting hole on channel should be 5mm.
- Riveting distance between each rivet in horizontal 450mm-600 mm c/c in elevation.
- Riveting distance between each rivet in vertical 300mm-450mm c/c in elevation.
- Riveting distance between each rivet in 300mm-450mm c/c in ceiling.
- For the edge plank. Or the start point from the edge of the wall, Riveting point marking will be 25mm in horizontal and 50 mm in vertical in order to match the centre of the aluminium section.
- Groove or Gap between each panel in horizontal & vertical should be 6mm-8mm.

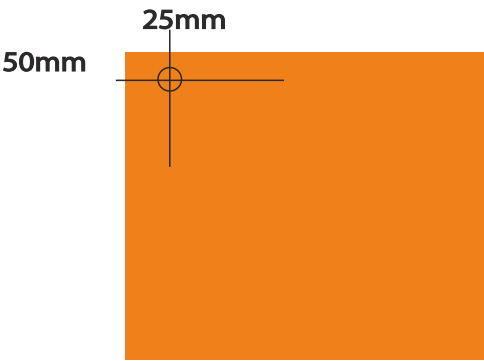



Wall Cladding- Adhesive based System

Adhesive system

Aluminum Substructure: The Aluminum substructure has to adhere to National standards and must be installed according to the specifications of the manufacturer for the substructure. It basically consists of vertical support profiles which are mounted on the wall using angle brackets.

Edge Spacing:

The Edge spacing must be kept in consideration for the reasons of stability and flatness, without fail. At least 8 mm wide joints must be made so that changes in size can take place without any interruptions. With the change in temperature, the metal sub-constructions change their dimensions. However the dimensions of claddings alter by relative humidity fluctuations. These changes in the size of sub construction and cladding material can be opposite to each other. While installing keen attention must be paid to the expansion clearance. The thumb rule for calculating required expansion clearance is:

X or Y(in mm)/500 = Expansion Clearance.

Preparation of Surface & Priming:

- **Abrasion:** Both the metal frame surface of the bonding area and the backside of HPL are abraded by using a cleaning pad / fine emery paper.
- **DO's:** Use Emery paper finer than 220 grit.
- **DON'TS:** Course abrasive product should not be used.
- **USES:** Abrasion improves adhesion by creating fine scratches and removes scales/other coatings.
- **Cleaning the Surface:** After the abrasion, surface is first cleaned with a dry cloth and then with 3M PU Cleaner. Wiping/cleaning has to be done in a single direction later allow the solvent to evaporate.
- **Priming:** Priming promotes adhesion. The surface of the bond need to be primed with 3M PU primer 595 black for durability.
- **Application:** For uniform coating on the surface primer can be applied either with brush or swab. The black film should be continuously wiped in a single direction. To achieve this in one stroke swab has to be soaked with enough primer. While applying the primer, reversing the direction of the swab/brush is not recommended. Application of the primer should be done only on the bonding areas and allowed to dry for leaving a tack free film. All these processes of surface cleaning has to be done just before the sealant application on the frame.
- To avoid dust accumulation on the surface, bonding should be completed at the earliest.

Very High Bond Tape and Sealant Application:

**Application of Very High Bond Tape:** As the extended exposure of Sealant bead will cause skin formation, VHB tape is advised to apply before opening the sealant pack. From the VHB Tape roll sufficient length has to be unwinded. Hold the edge of the tape, and the portion where it is touched by the fingers outside must left. Press the tape end to the frame, it should be aligned towards the outer edge of the frame. For bubble free application of the tape, 3M HTA is recommended. Wherever the tape needs to be joined an overlap should be given then cut the overlapping edges of the tape to get a cleat but-joint. With the help of squeegee or rubber roller, press the tape to ensure proper surface contact and to initiate the flow.

**Application of Sealant:** Application of sealant as triangular bead of 6-8 mm base with a gap of 10-12 mm from the tape is recommended. To get the triangular bead the nozzle of the sealant sausage / cartridge should be cut at a proper length with a 'V' notch. Apply sealant as a continuous bead with the uniform dimensions. The triangular shape of the bead helps to get maximum contact area in between the sealant and the panel, when squeezed, and a near rectangular bead. Cladding and the sealant application should be completed, within the skin formation time of the sealant,.

**Panel Cladding:** After removing the liner from the tape, place the panel without pressing, to bond over the tape and sealant bead. To get a proper alignment the panel can be moved at this point, as it is not touched on the tape surface. There should not be much movement while aligning, to avoid any contamination of tape bonding surface with sealant. Once the alignment is done properly, push the panel to lock in that place and by using a rubber roller or by hand pressure press it down. Bond strength depends on the amount of adhesive to surface contact developed. Pressure should be applied in such a way so that both the surfaces contact the tape fully. As the adhesive flows onto the surface the bond will increase.

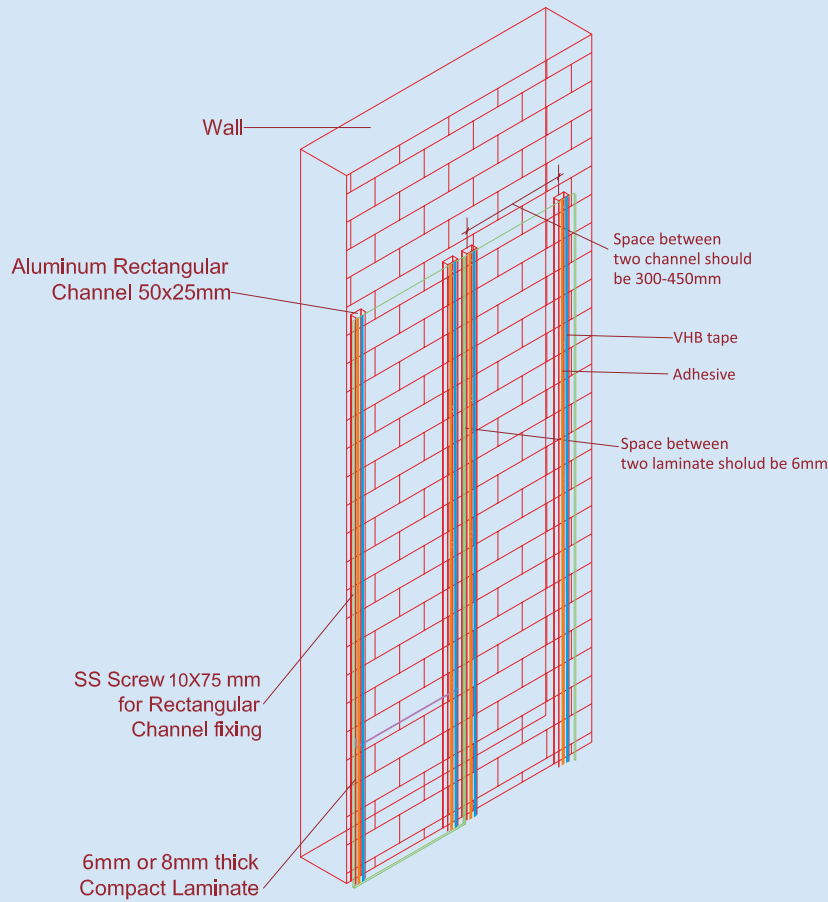

Wall Cladding- Concealed Mounting system (Z-Clip Type)

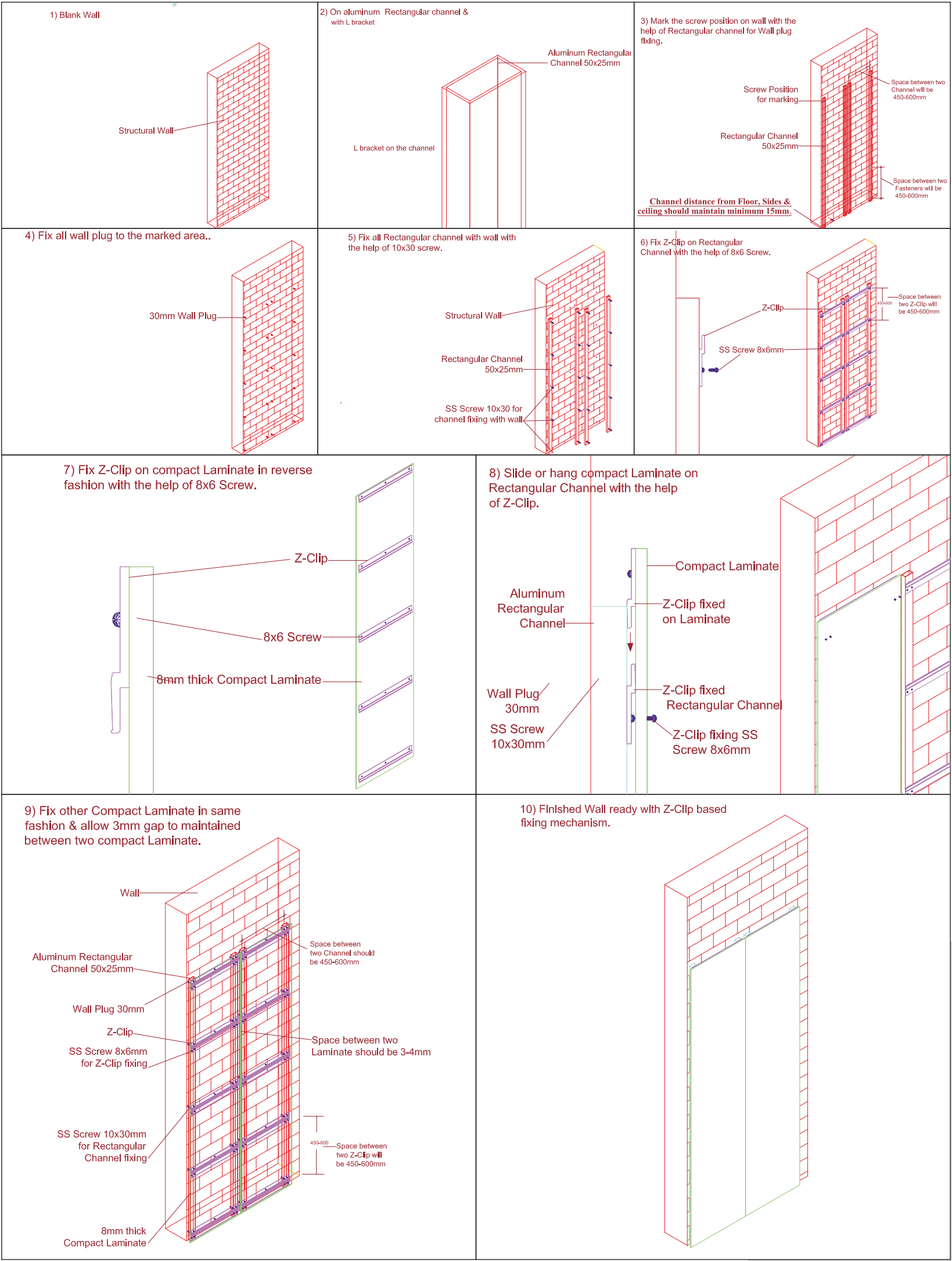



Exterior Grade High Pressure Compact Laminate

TECHNICAL SPECIFICATIONS

Size: 2440mm x 1220mm

Sr No.	Properties	Specification As per EN 438 - Part 6	Amulya Values
1	Thickness (mm.) (max.)	6.00 ± 0.40 mm.	6.10 mm.
2	Length (mm.)	2440.00 + 10.00 /-0.00 mm.	2441.00 mm.
3	Width (mm.)	1220.00 + 10.00 /-0.00 mm.	1221.00 mm.
4	Edge straightness mm. (max.)	1.50 mm. / m	0.88 mm. / m
5	Edge squareness mm. (max.)	1.50 mm. / m	0.80 mm. / m
6	Flatness (mm.) (max.)		
	2.00 ≤ t < 6.00 (mm.)	8.00 mm. / m	3.60 mm. / m
	6.00 ≤ t < 10.00 (mm.)	5.00 mm. / m	2.40 mm. / m
	t ≥ 10.00 (mm.)	3.00 mm. / m	1.50 mm. / m
7	Tensile Strength (min.)	60 Mpa.	68 Mpa.
8	Density, gm. / cm <sup>3</sup> (min.)	1.35 gm. / cm <sup>3</sup>	1.48 gm. / cm <sup>3</sup>
9	Resistance to wet conditions		
	a) Mass increase (%) max.		
	2.00 ≤ t < 5.00 (mm.) (t = normal thickness)	10%	3.20%
	t ≥ 5.00 mm.	8%	2.50%
	b) Appearance not worse than	Rating 4	Rating 5
10	Dimensional Stability at elevated temperature.		
	2.00 ≤ t < 5.00 (mm.) (t = normal thickness)		
	a) Longitudinal, % max.	0.40%	0.20%
	b) Transverse, % max.	0.80%	0.40%
	t ≥ 5.00 mm.		
	a) Longitudinal, % max.	0.30%	0.20%
	b) Transverse, % max.	0.60%	0.35%
11	Surface Burning Test.		
	As Per ASTM E84-16, CLASS-A		
	a) Flame Spread Index (FSI)	0 - 25	5
	b) Smoke Developed Index (SDI)	0 - 450	30

Note: Sample shown in this catalogue is just for color & pattern reference only, actual sheet sample pasted below.

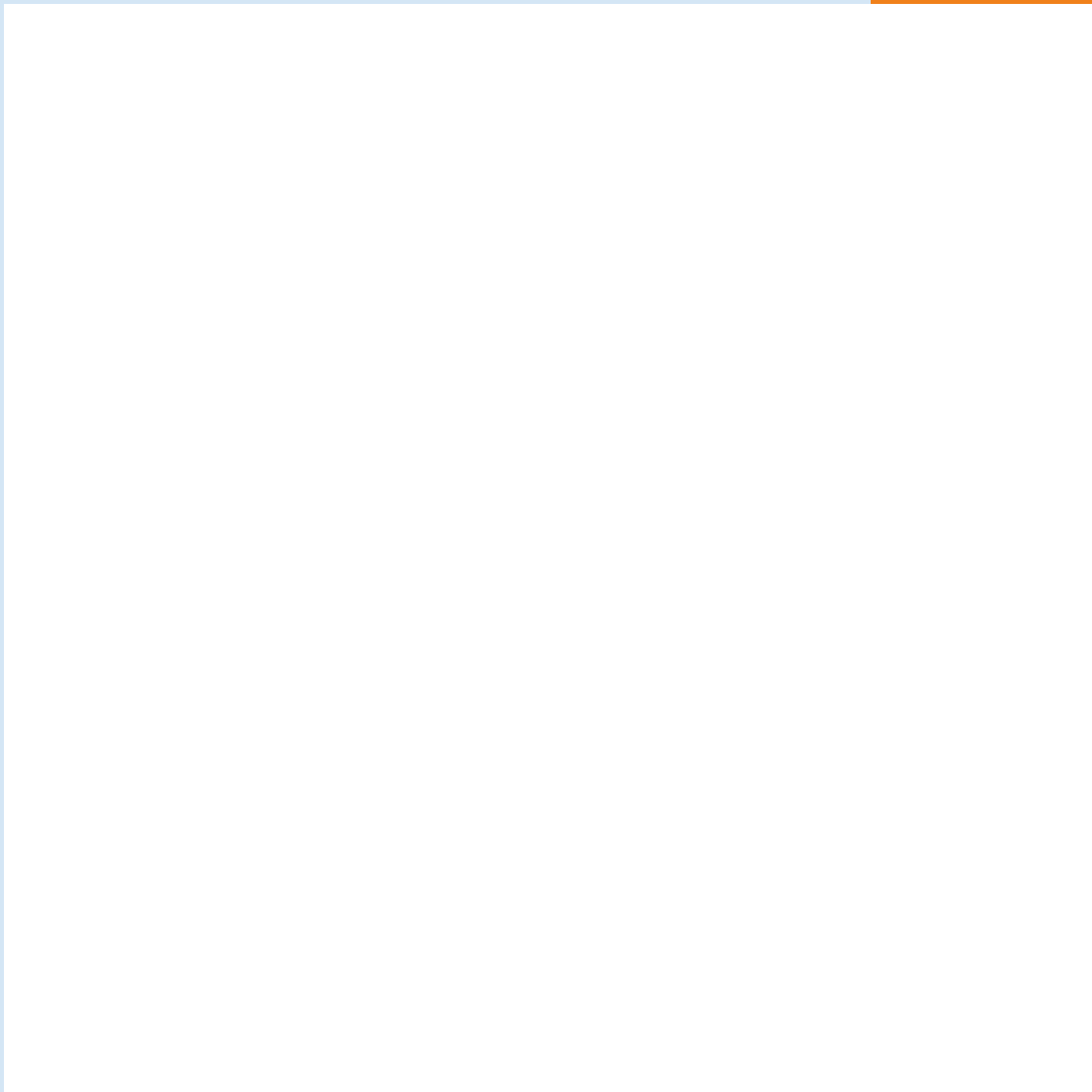

Product Sample

Certification

